

1 2 3 4 5 6 7

A

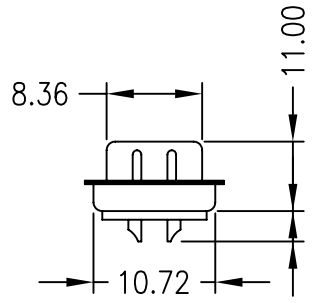

B

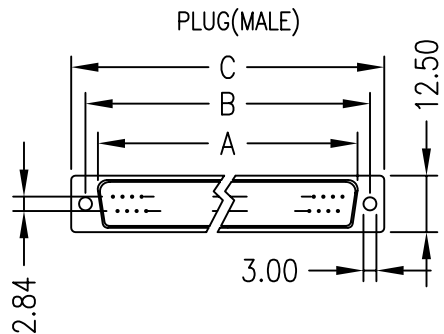
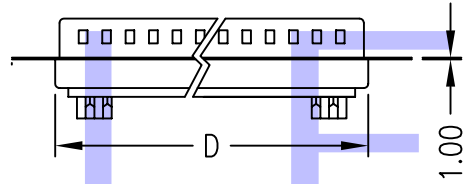

4.0±0.1

C

SOCKET(FEMALE)

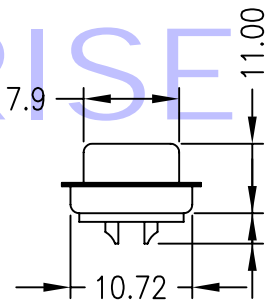
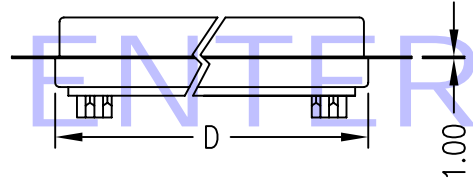

4.0±0.1

D

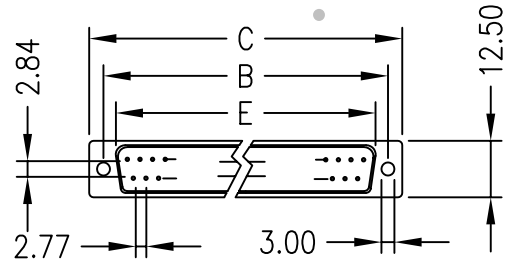

| Positions | A ±0.25 (0.010) | B ±0.13 (0.005) | C ±0.38 (0.015) | D ±0.25 (0.010) | E ±0.25 (0.010) |
|-----------|-----------------------|-----------------------|-----------------------|-----------------------|-----------------------|
| 09 | 16.92 0.666 | 24.99 0.984 | 30.81 1.213 | 19.28 0.759 | 16.33 0.643 |
| 15 | 25.25 0.994 | 33.32 1.312 | 39.14 1.541 | 27.65 1.089 | 24.66 0.971 |
| 19 | 30.60 1.205 | 38.86 1.530 | 44.85 1.766 | 32.86 1.294 | 30.07 1.184 |
| 23 | 36.00 1.417 | 44.28 1.743 | 50.27 1.979 | 38.38 1.511 | 35.54 1.399 |
| 25 | 38.96 1.534 | 47.04 1.852 | 53.04 2.088 | 41.30 1.626 | 38.38 1.511 |
| 37 | 55.42 2.182 | 63.50 2.500 | 69.32 2.729 | 57.44 2.261 | 54.84 2.159 |

A

B

C

D

E

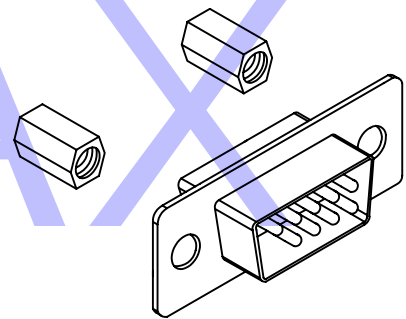

SPECIFICATIONS

Insulator :PBT+30% glass fiber , UL 94V-0
 Contact : Brass or Phosphor bronze
 Current rating (Max) : 5 amp AC / DC
 Withstanding voltage : 1000 VAC
 Insulation resistance (Min.):1000M Ω
 Contact resistance (Max):30M Ω
 Operating temperature : -55°C~+105°C

| | | | | | | | |
|---|-------|----------|----------|-------------------------------|---------|-----------------|--|
| 易昕企業有限公司 LEAMAX ENTERPRISE CO., LED. | | PROJ | | SCALE : F DO NOT SCALE DWG | | MOLD NO 3220 | |
| | | APP | 92.11.17 | MODEL | FILE NO | REV. | |
| CHK | CCJ | 89.10.25 | | CODE2 | X1 | | |
| DGN | WU | 89.10.25 | UNIT | SHT 1 OF 1 | SIZE | | |
| DRW | SHIEH | 89.10.25 | MM | | A4 | | |

1 2 3 4 5 6 7